



CONDITIONAL USE APPLICATION

APR 24 2024

1. MUNICIPAL USE ONLY		
Received: <u>4/24/24</u>	When ready: <input type="checkbox"/> Email <input type="checkbox"/> Call	Received as: <input checked="" type="checkbox"/> Walk-in <input type="checkbox"/> Mail
Application Received by: <u>Tracey Franey</u>		<input type="checkbox"/> Email
Received from Applicant: <input type="checkbox"/> List of names and addresses of all property owners within 500' of property <input type="checkbox"/> 3 copies of proposed plans <input type="checkbox"/> Related information described in Zoning Ordinance		
Application Fee (DUE AT SUBMISSION): <input type="checkbox"/> \$1,000.00 Residential <input checked="" type="checkbox"/> \$4,000.00 Commercial		<input type="checkbox"/> Cash <input type="checkbox"/> Check # <u>Credit Card</u> Date Received: <u>4/24/24</u>

2. PROPERTY INFORMATION	
Site Address: 1406 Hollow rd., Birchrunville, PA 19421	
Tax Parcel ID: 25 - <u>4</u> - <u>80</u>	Lot # (if applicable):
Type of property: <input type="checkbox"/> Residential <input checked="" type="checkbox"/> Commercial	

3. OWNER	Email: <u>rkullanna@gmail.com</u>
Name: <u>Ruthairat Pascal & Francis Pascal</u>	Phone: <u>484 222 1059</u>
Address/City/State/Zip: <u>218 Nottingham drive, Spring city, PA 19475</u>	

4. APPLICANT	Email:	<input checked="" type="checkbox"/> Same as owner
Name:	Relationship to owner:	
Company (if applicable):	Phone:	
Address/City/State/Zip:		

5. REASON FOR APPLICATION	
Applicant desires to use property in the following manner as permitted as a Conditional Use under Section <u>390-219</u> of the West Vincent Township Zoning Ordinance (attach documents if needed): <u>outside seating, occasional live music, backroom seating, parking, baking on premise.</u>	
Owner's Signature <u>[Signature]</u>	Applicant's Signature <u>[Signature]</u>

Applicant must also complete the Chester County Planning Commission Act 247 County Referral Form which can be found at <https://www.chescoplanning.org/pdf/247-Referral-Form.pdf> (referral form also requires one complete set of plans and a separate review fee payable to the county).

Butterscotch

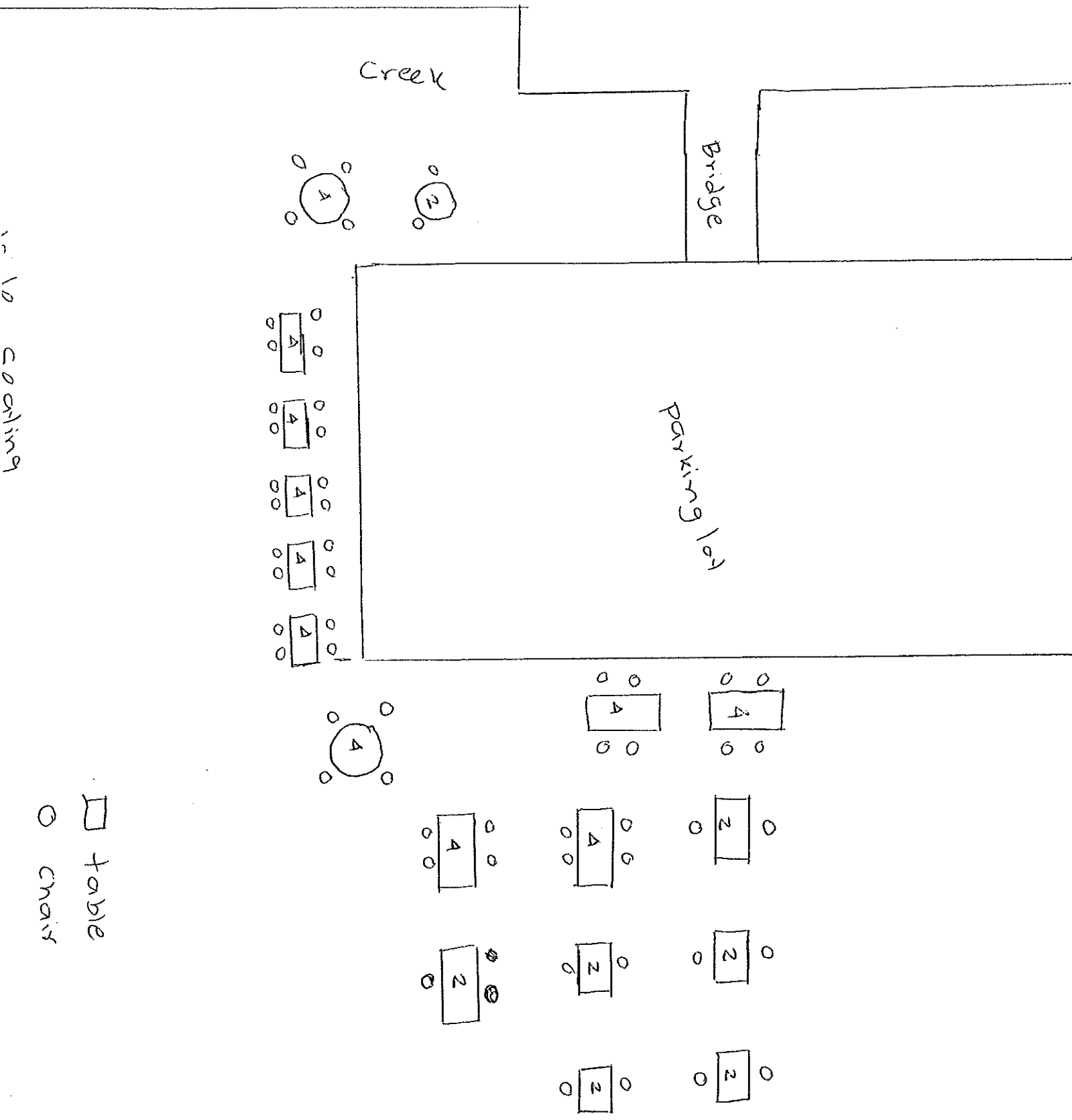

1-10 Cooking

▭ table
○ chair

↘ N

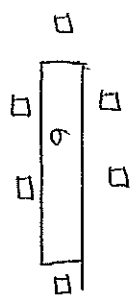
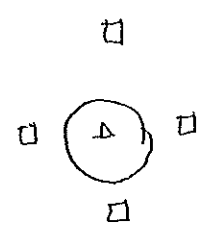
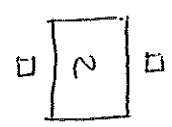
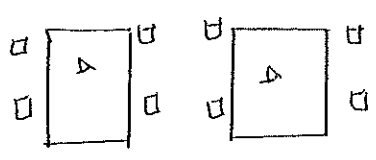
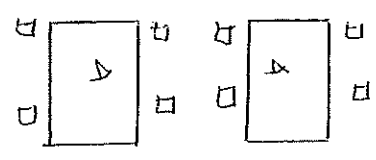
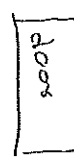
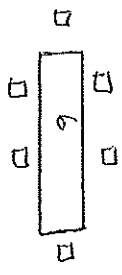

stairs to
upstairs

stairs

"Back room"

□ chairs

▬ tables